

CRT-603-7005 Card scanning module specification



1. Introduction

This product designed background is based on Chinese resident ID card information acquisition, which contains the front and back image scanning function of ID card, and also reads the chip data of the second generation ID card. With the increasing demand for identity checking, this product is widely used in public security, finance, insurance, telecommunications, hotels and other places that require identity acquisition.

The main features of this equipment are as follows:

- Double-sided scanning of 2nd generation ID cards and aliens permanent residence identity card images
- Synchronously read all the information of 2nd generation ID cards and foreigners' permanent residence identity cards when scanning.
- Store color ID card images
- As a single computer directly connected to the desktop.
- Being embedding terminal devices as internal modules
- Force to eject the card by pressing the key.
- Support for the application software development through SDK
- Compatible with scanning of bank cards and other size cards (The card thickness is 0.5mm~1.2mm)

2. Product specification

System platform	Windows	Support Win7 or above system 64/32 bit
	Linux	Driver provided
	Android	Driver provided
Scan	Sensor type	CIS (Contact image sensor)
	Scan type	Front, back, double-sided scanning
	Scan resolution	300dpi
	Light source	R, G, B
	Image type	Color
	Scanning width	54mm
	Scanning length	86mm
	Card thickness	0.5~1.2mm
	Scanning speed	Image scanning speed <85mm/s ID card reading + image scanning time <3s
	Auto cut off	Support
	Automatic rotation	Support
Eject card	Eject card mode	Hold the card, directly eject
	Eject card type	Eject card when power off, forced ejecting card.
Others	ID card information reading	2 nd generation ID card, permanent residence identity card for foreigners
	Hong Kong and Macao pass	support
	Short card detecting	Support (automatically eject)
	Mandatory of card returning	Support
	Indicator light	Power indicator lamp Status indicator lamp
	Communication interface	USB 2.0
	Application program (Demo)	Support Windows 7/Windows 8/Windows 10
	SDK	Support
	Dimensions	140mm×85mm×45mm
	Power supply	DC12V±10% 2A
	Work temperature	-5~45℃
	Storage temperature	-20~60℃
	Humidity	5%~95%(no condense)

3. CRT-603-7005 product outline

3.1 Overall prototype drawing



3.2: Front view of card reader



3.3 Rear view of card reader



3.4 Internal view of card reader



4. Product diagram

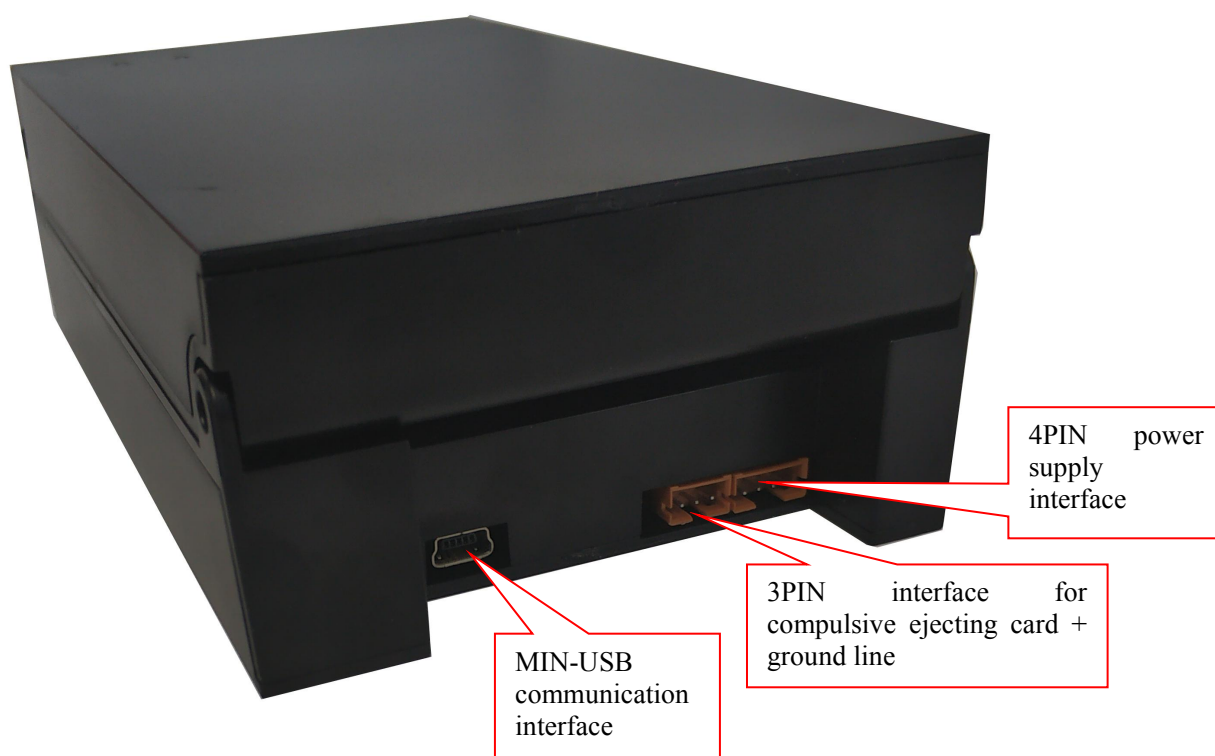
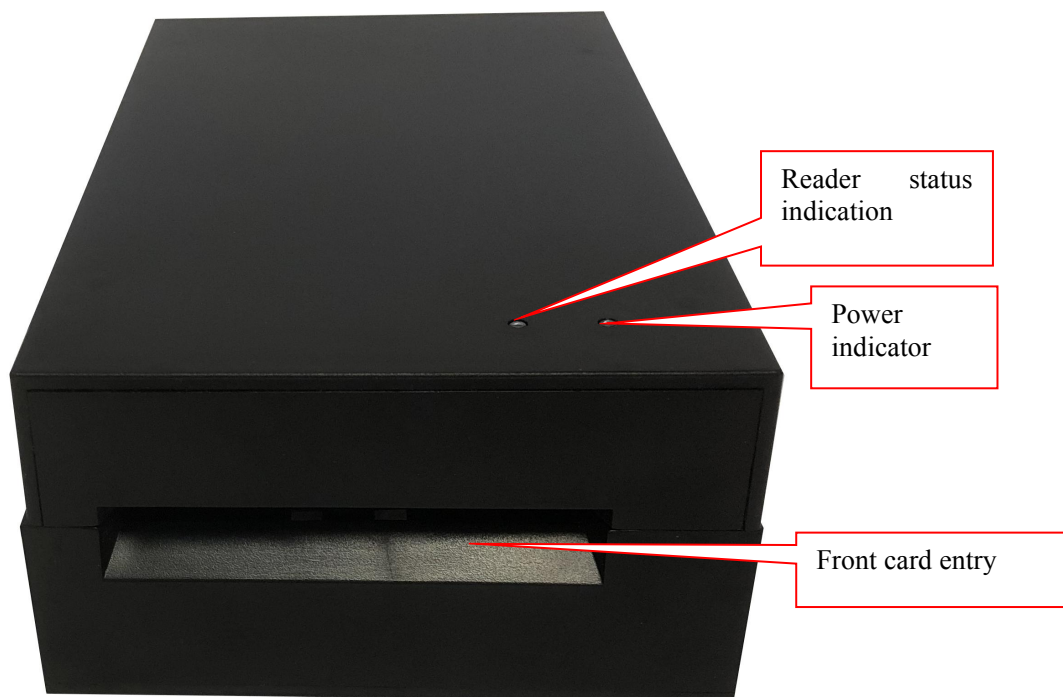

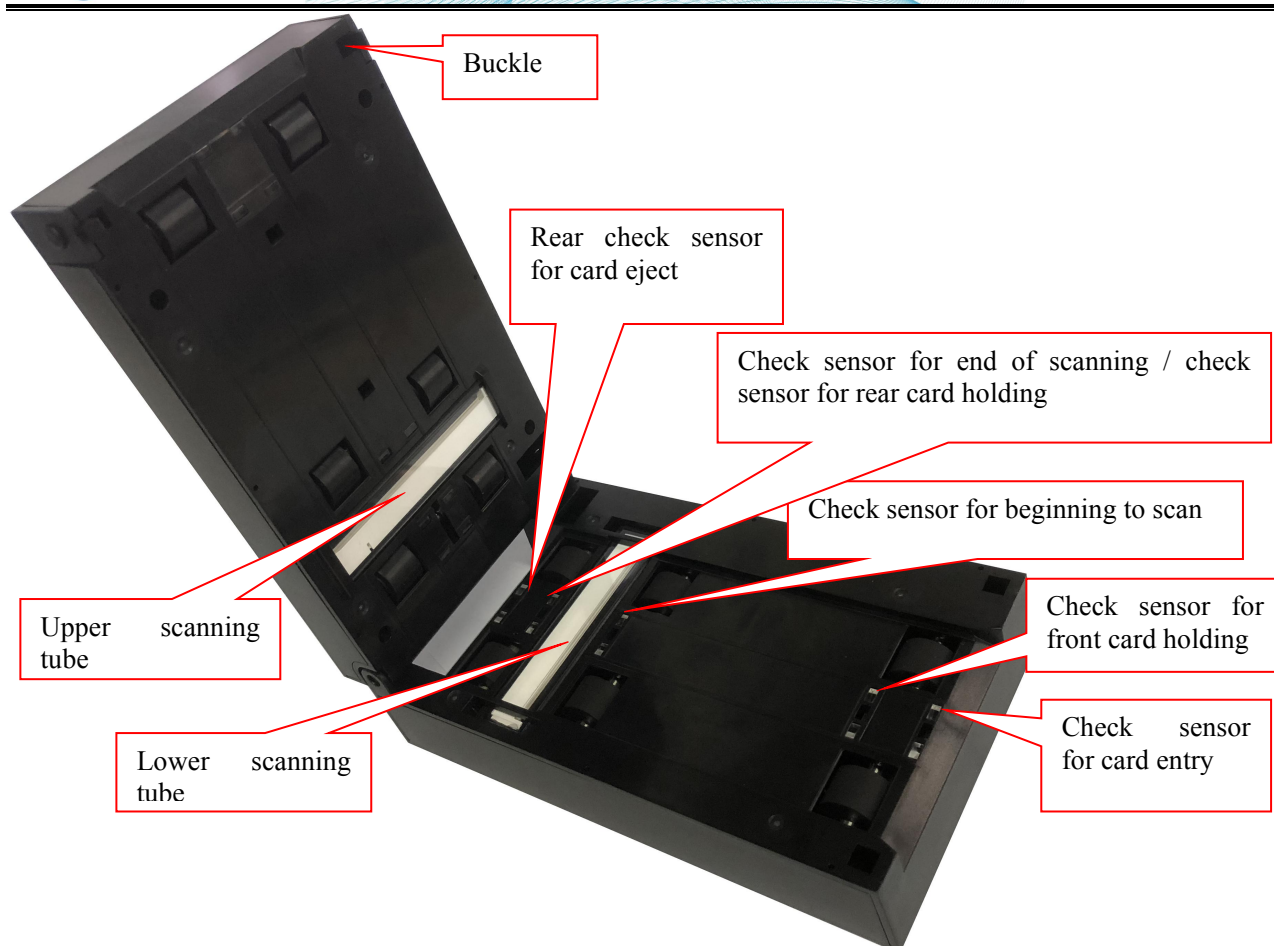

5. Schematic diagram of accessories

5.1 Power supply cable

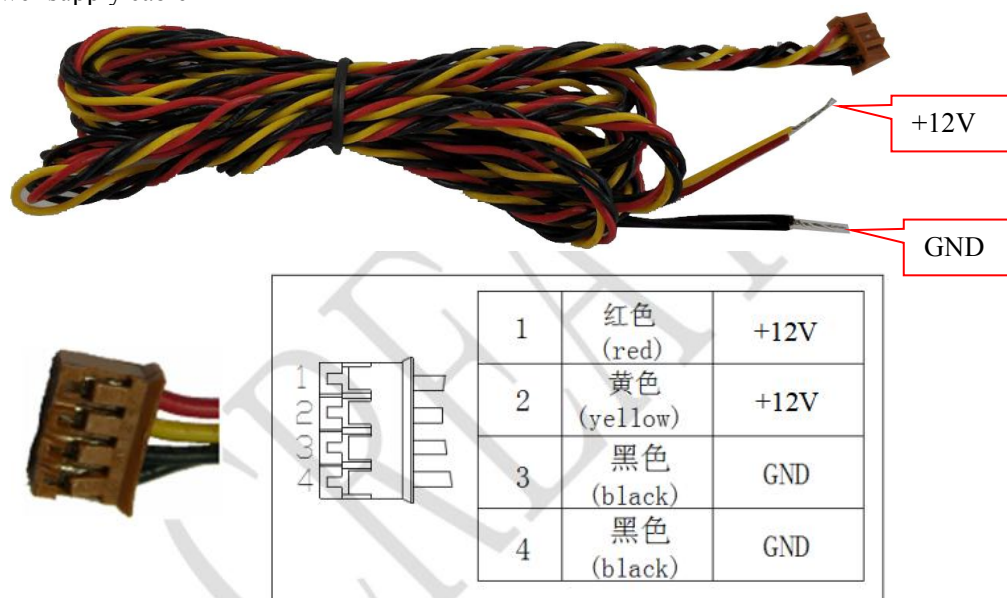

5.2 USB communication cable

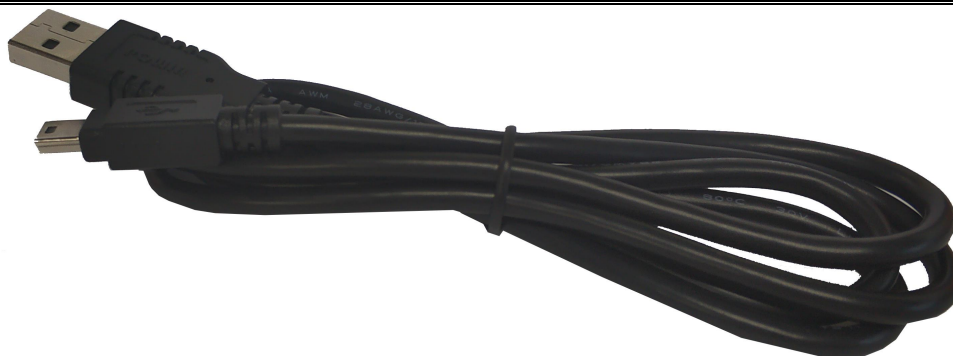

5.3 Compulsion of card returning line + ground line

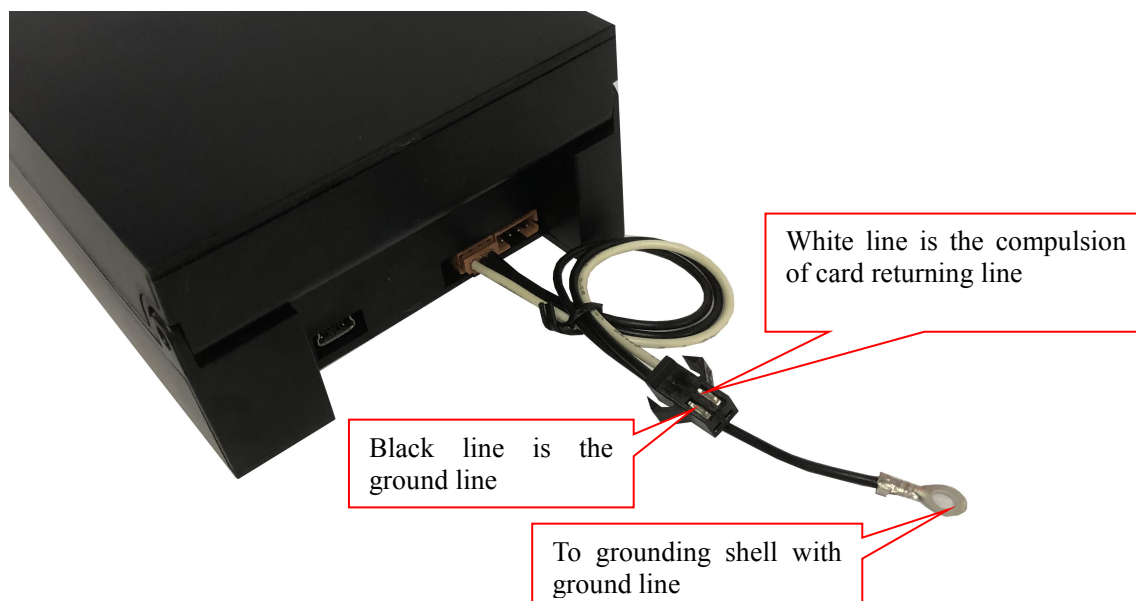

5.4 Backup power supply for ejecting card when power off (achieve ejecting card when power off)

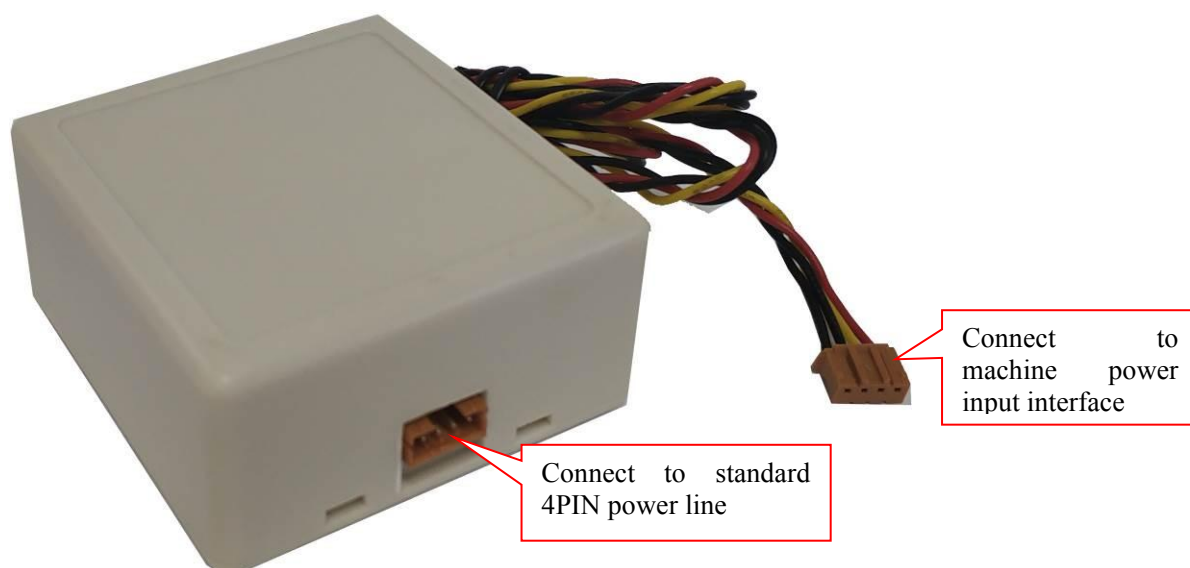

6. CRT-603-7005 product dimensions

